



Neighborhood Association

4121 South 6th Street
Milwaukee, WI 53221
(414) 379-2450

www.Milwaukeegdna.com
info@milwaukeegdna.com

Connie Wilson
Chairperson

Samer Abulughod
Vice-Chairperson

Julia O'Connor
Treasurer

Jennifer Gordon
Secretary

Board Members

- Jim Baker
- Sue Beecher
- Jared Bell
- Marshall Lee
- Bobbie Rezutek
- Dawn Riegel
- Bryan Simon
- Kristin Stieger
- Debbie Stoddard

County Supervisor
Jason Haas
Ald. Terry Witkowski
Ex-Officio Member

The Garden District
Neighborhood
Association is a
nonprofit organization
[501(c)(3)] dedicated
to serving and
improving the quality
of life for those who
live in the 13th
Aldermanic District in
the City of Milwaukee

Dear Neighbors and Friends of the Garden District Neighborhood Assn:

The Garden District Neighborhood Association, also known as the GDNA, is a nonprofit organization whose purpose is to help improve and enhance the quality of life for the Garden District residents, to educate and engage our youth, and strengthen the economy of the city's local neighborhoods that surround the airport.

The GDNA is looking for donations from the community to help fund projects that are going on around your neighborhoods within the Garden District. The GDNA has established three committees to better serve the needs of the community, including the Garden Committee (supporting the beautification of the GDNA District), Neighborhood Association Committee (helping neighborhood association leaders to succeed), and the Civic and Educational Committee (improving, educating, and protecting neighbors in the GDNA District).

The GDNA is involved in many projects at this time. Our Garden Committee organizes an annual business and residential garden awards program designed to encourage beautification of our business and neighborhood corridors to promote "curb appeal".

The GDNA is also in the process of building and supporting the community garden located at 6th & Howard which includes garden plots for neighbors to rent, installing a gazebo and is hosting a farmers market at this location.

We are also supporting the Green Corridor (previously known as the Green Street), an initiative to promote sustainable environmental initiatives and related business development along South 6th Street from Howard Avenue to MATC located in Oak Creek. Addressing issues such as the periodic flooding along Wilson Creek by rechanneling storm water runoff to irrigate area landscaping and keep rain where it falls.

This combination of people, enthusiasm and commitment will demonstrate the success necessary to guide and inform the development of the City's first sustainable complete street. South 6th Street serves as a transportation corridor from Downtown Milwaukee to the Airport and the Amtrak station with high public visibility and opportunities for promotion. The Green Corridor is not supported by your tax dollars.

Our activities are intended to help activate neighborhood associations and promote business interest in area beautification.

Words alone cannot express how thankful and humbled the GDNA is for your donation. If you have any questions, please direct those questions to The GDNA email at info@milwaukeegdna.com or feel free to call 414-379-2450.

ADOPT-A-BRICK

Bricks will be set in the entrance to the stage area off of 6th Street between the Community Garden on Howard and the Farmer's Market on Norwich.

\$100.00 Platinum Member: The GDNA will acknowledge your donation/support with a brick engraved with an inscription of your choice, up to 3 lines with 14 characters per line. Please return the completed form and your check or cash to:

The GDNA Fundraiser
4121 South 6th Street
Milwaukee, WI 53221

\$50.00 Gold Member*

\$25.00 Silver Member*

\$24.99> Bronze Member*

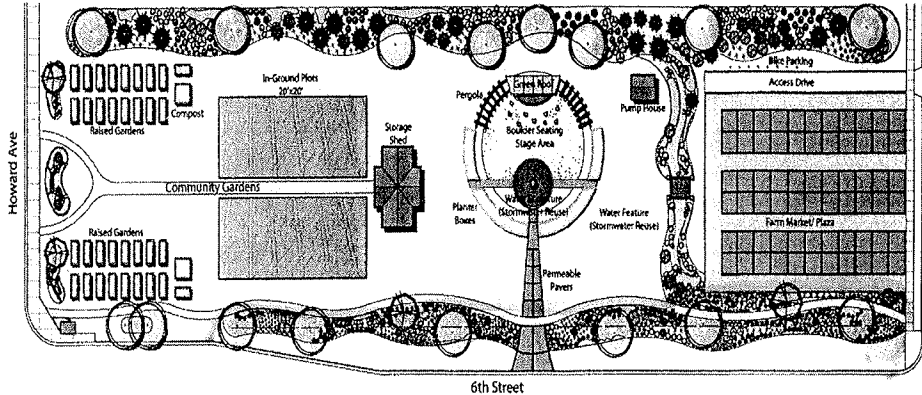

* All names will be included in the GDNA upcoming flyer unless otherwise noted to **NOT** be included. Please check if you want your name to appear in the flier: Yes _____ No _____

PLEASE NOTE: *All donations are tax deductible*****

ADOPT-A-BRICK ORDER FORM:

PURCHASER INFORMATION:

Name: _____

Address: _____

Phone Number: _____

Method of Payment: Cash: \$ _____ Check: \$ _____ Check: # _____

BRICK INFORMATION:

4" X 8" Brick _____

Max 14 characters/3 lines _____

Please review all information and initial here: _____